

# MMC series male thread



## Specification

- Housing** Manganese molybdenum steel.  
Phosphated all over.
- Ball** 1% carbon chromium steel.  
Heat treated.  
Chromium plated on the spherical surface.
- Liner** Reinforced PTFE.
- Stainless steel** All the units on this page are available in stainless steel. The last letter of the designation changes from C to R. All dimensions are unchanged.

### Temperature and fits

The normal maximum operating temperature for these rod ends is 120°C, although Rose Bearings technical department should be consulted where the normal operating temperature exceeds 80°C. There is no measurable clearance in these rod ends in the no load condition, and the tightness of the rod end is measured by the breakaway torque as indicated below.

Bearing size No load breakaway torque (Nm)

MMC

05 – 20

0 – 0,56

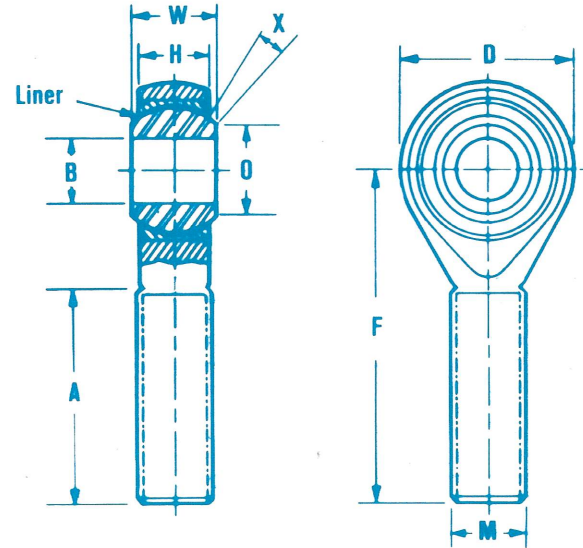

## Metric dimensions

Bearing number	B	W	H	O	D	F	A	M	X	Ball dia nom	Maximum static radial load in Newtons approx	Weight in kg each approx
	Bore	Ball width	Housing width	Ball flat dia	Head dia	Centre length	Thread length	Thread size	Angle deg			
	H7	+ 0 -0,1	+0,1 -0,1		+0,2 -0,2	+0,2 -0,2	Min	ISO medium fit				
<b>MMC 05</b>	5	8	6,0	7,7	18	33	19	M5 x 0,8	17,0	11,11	7 880	0,013
<b>MMC 06</b>	6	9	6,75	8,9	22	36	21	M6 x 1,0	16,0	12,70	11 110	0,019
<b>MMC 08K</b>	8	12	9,0	10,4	26	42	24	M8 x 1,25	17,0	15,87	20 720	0,032
<b>MMC 10K</b>	10	14	10,5	12,9	30	48	28	M10 x 1,5	16,0	19,05	33 220	0,054
<b>MMC 12K</b>	12	16	12,0	15,4	34	54	32	M12 x 1,75	15,0	22,22	47 790	0,085
<b>MMC 14K</b>	14	19	13,5	16,8	38	60	35	M14 x 2,0	18,0	25,40	47 720	0,125
	H7	+ 0 -0,1	+0,1 -0,1		+0,7 -0,3	+0,7 -0,3	Min					
<b>MMC 16K</b>	16	21	15,0	19,3	42	66	39	M16 x 2,0	17,0	28,57	60 230	0,185
<b>MMC 18</b>	18	23	16,5	21,8	46	72	43	M18 x 1,5	16,5	31,75	71 580	0,260
<b>MMC 20</b>	20	25	18,0	24,3	50	78	46	M20 x 1,5	15,5	34,92	83 720	0,340

For left hand thread insert L in bearing number eg. MMLC 05.

Other bearings outside the above range can be obtained, but will not be so readily available.